

PROJECT

**CITYSIDE LOFTS
PHASE I**

42 UNIT RESIDENTIAL
412 SOUTH 13TH ST.
BOISE, IDAHO

PROJECT #06-201

SEAL



This document is the property of THE ARCHITECTS OFFICE, PLLC and is not to be duplicated without written authorization.
© THE ARCHITECTS OFFICE, PLLC

FILE

DATE MAY 16, 2006

PROJECT 06-201 BASEMENT PH I

DESIGNER JP

REVISIONS

SHEET

PHASE I

A2.0

BASEMENT PLAN

S. 13TH STREET

W. GRAND AVENUE

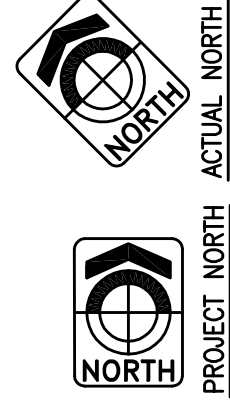
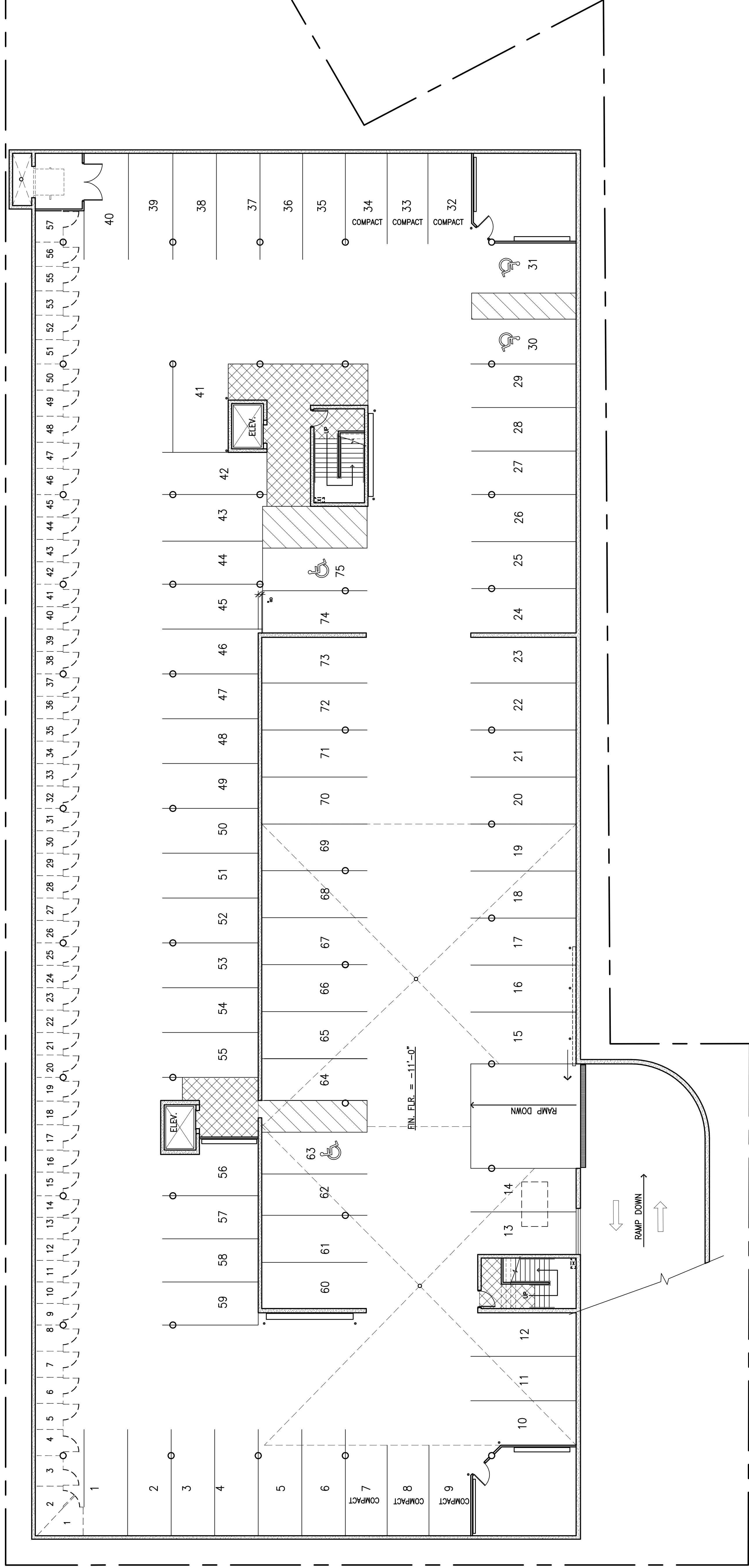

1 BASEMENT PLAN - PHASE I

SCALE: 3/32" = 1'-0"